

Índice | Index

Introducción: La Empresa Introduction: The Company	3
Cabinas Fenólicas Phenolic cabins	4
Gama de colores y herrajes Range of colours and metalworks	
Tipo de distribuciones / Type of distributions	
Encimeras y separadores unirarios Tops and Urinary spacers	7
Taquillas Lockers	8
Opciones de taquillas / Lockers' options	
Gama de colores y complementos Range of colours and complements	
Bancos y percheros Benches and hooks	11
Tipos / Types	
Gama de colores Range of colours	
Certificados Certificates	14
Galería Gallery	15

La Empresa | The Company

Spigogroup es una empresa enfocada a la fabricación de soluciones en madera que aportan diseño y calidad en todos sus proyectos. Ayudamos a prescriptores y constructores ofreciéndoles las múltiples opciones y variedades de productos en madera con el fin de obtener los mejores resultados para los proyectos más exigentes.

Gracias a su constante inversión en Investigación y desarrollo (I+D), la empresa amplía sus productos en la división de MOBILIARIO DEPORTIVO bajo su marca comercial Spigocompac.

Con Spigocompac, queremos abarcar toda la carpintería especializada en mobiliario deportivo, como cabinas fenólicas, taquillas de vestuario, bancos, encimeras...

Spigogroup is a company which is focused to the production of wooden solutions, who provide design and quality in every project. Spigogroup helps consultants and builders, providing them with the many options and varieties that wooden products offer in order to obtain the most demanding projects.

Owing to our constant investment in Research and Development (R&D), the firm increases its multi-product divisions, so we offer you our SPORT FURNITURE, under its commercial name Spigocompac.

With Spigocompac, we want to include the carpentry specialized in sport furniture, such as Phenolic cabins, lockers, benches, worktop...

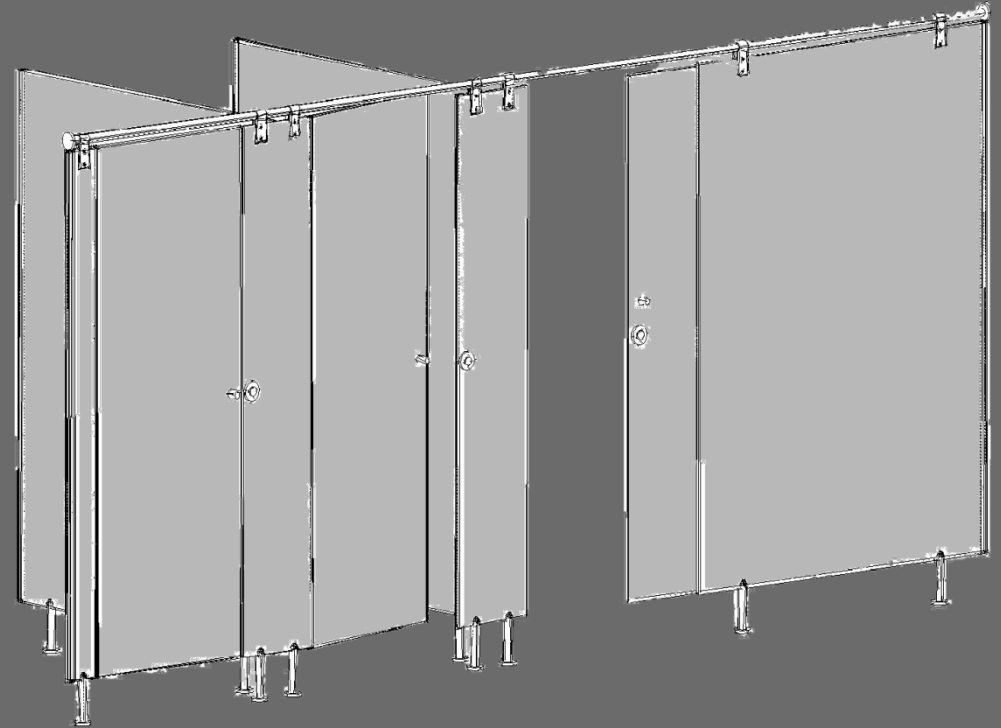



- Fabricadas con panel compacto fenólico de 12 mm de espesor
- Alta resistencia al rayado, al desgaste, al impacto, a productos químicos...
- Comportamiento seguro al fuego.
- Superficie no porosa, que repele a la suciedad. Mantenimiento sencillo.
- Sistema montaje mediante herrajes de acero inoxidable AISI 304
- They are produced with Phenolic compact panel of 12 mm of thickness.
- High resistance against scratch wears impact, chemical products.
- Sure behavior against fire.
- Surface is non-porous; dirt does not adhere to it. Simply maintenance.
- Method of assembly is by some stain steel metalwork AISI 304

Cabinas fenólicas: Gama de colores y herrajes | Range of colours and metalworks

GAMA DE COLORES STOCK | STOCK RANGE OF COLOURS

Azul Claro | Light blue Gris oscuro | Dark grey Gris claro | Light grey



Rojo | Red



Blanco | White

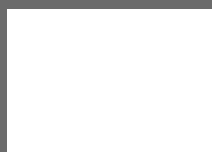

Negro | Black

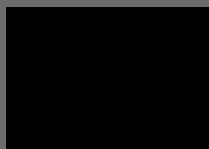

Verde | Green

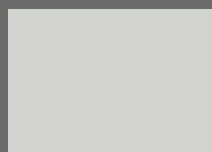

Amarillo | Yellow



Azul | Blue

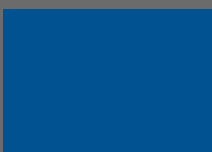

HERRAJES | METALWORKS



Pomo | Doorknob



Soporte tubo-pared | Support tube-wall



Soporte tubo-tablero | Support tube-panel



Perfil U | U Profile



Tubo cabina | Cabin tube



Muletilla Con Desbloqueo | Unblocking toggle



Soporte suelo-tablero | Support floor-panel

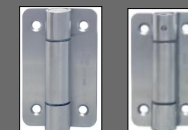

Bisagra c/s muelle | Hinge with/without spring



Puerta corredera | Sliding door



Conector | Conector

Cabinas fenólicas: Tipo de distribuciones | Phenolic cabins: Types of Distributions

Cabina simple | Simple cabin

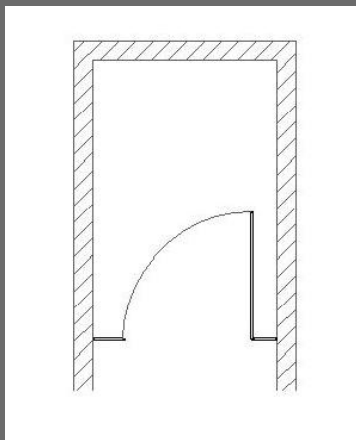

Cabina doble | Double cabin

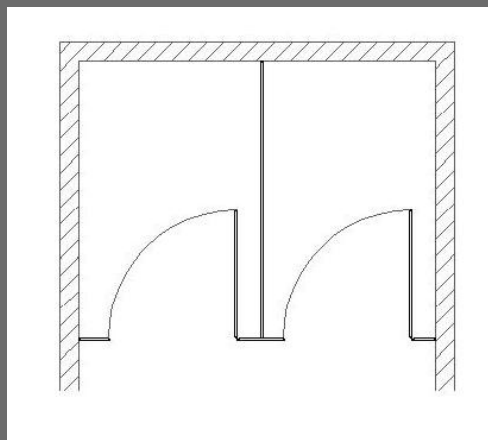

Cabina Triple | Triple cabin

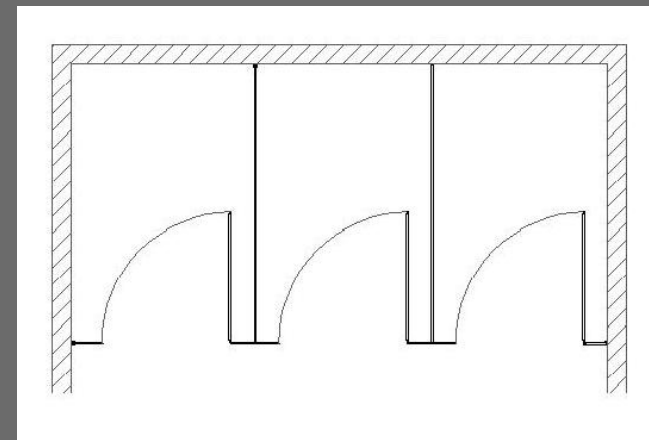

Cabina con puerta especial adaptada
Adapted and special door cabin

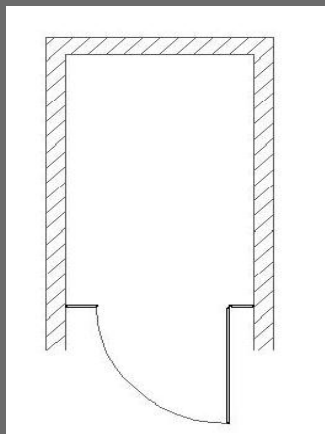

Cabina Triple con Puerta corredera | Triple cabin with sliding door

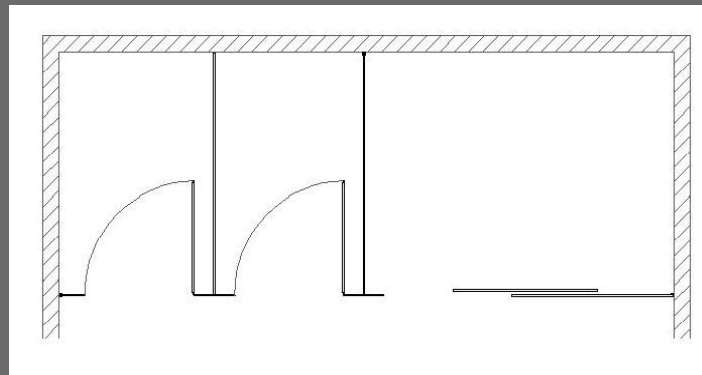

Encimeras y separadores urinarios | Tops and urinary spacers

GAMA DE COLORES STOCK | STOCK RANGE OF COLOURS

Azul Claro | Light blue Gris oscuro | Dark grey Gris claro | Light grey



Rojo | Red



Negro | Black

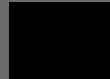

Amarillo | Yellow



Blanco | White



Verde | Green

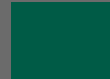

Azul | Blue

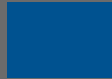

- Panel compacto fenólico de 12 mm de espesor
- Alta resistencia al rayado, al desgaste, al impacto, a productos químicos...
- Superficie no porosa, que repele a la suciedad. Mantenimiento sencillo.
- Phenolic compact panel of 12 mm of thickness.
- High resistance against scratch wears impact, chemical products...
- Surface is non-porous; dirt does not adhere to it. Simply maintenance.

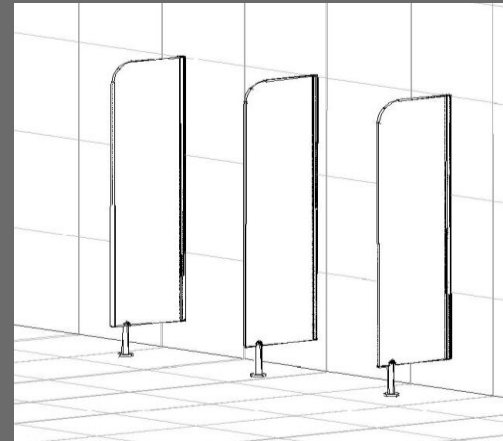
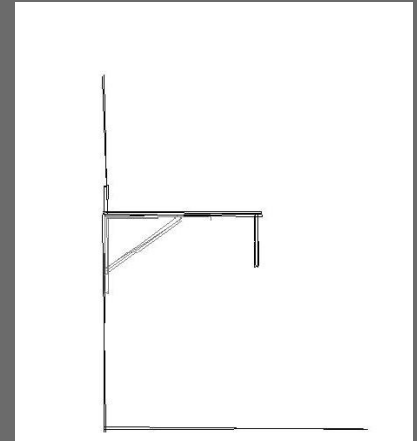
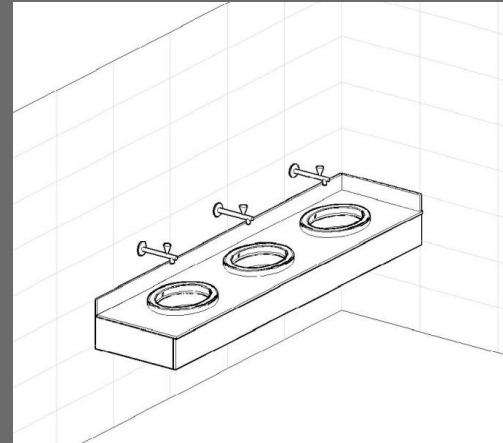



- **Tablero compacto fenólico.**
 - **Sistema de ventilación óptimo para cada compartimento con trasera perforada de DM blanco de 3 mm.**
 - **Resistentes al rayado, al desgaste y comportamiento seguro al fuego. Superficie no porosa, repele la suciedad. Mantenimiento sencillo.**
 - **Diferentes tipos de cerradura: resbalón, moneda.**
-
- **Phenolic compact panels.**
 - **They have an optimum vent system for each compartment, with white DM of 3 mm perforated back.**
 - **Scratch and wear resistance and a sure behavior against fire. Surface non-porous; dirt does not adhere to it. Simply maintenance.**
 - **Different types of lock: removable cylinder, coin**

Taquillas: Opciones de taquillas | Lockers: Lockers' options

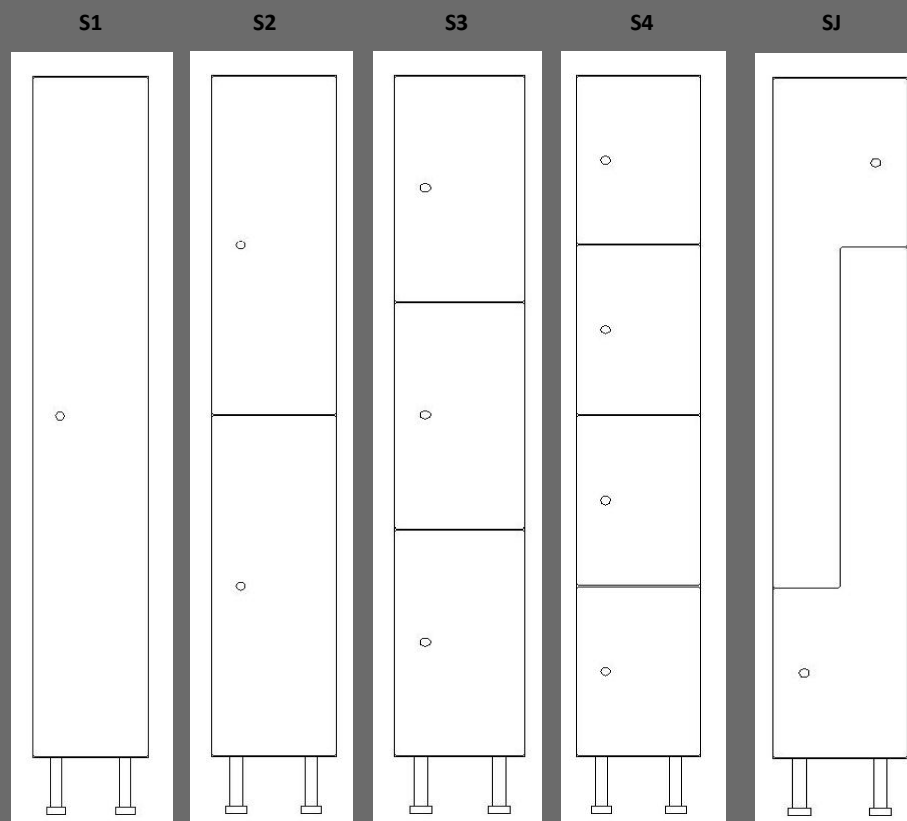

SERIES	ALTO ↕	ANCHO ↔	FONDO ↗	Nº PUERTAS
S1	1800 mm.	300/400 mm.	500 mm.	1
S2	1800 mm.	300/400 mm.	500 mm.	2
S3	1800 mm.	300/400 mm.	500 mm.	3
S4	1800 mm.	300/400 mm.	500 mm.	4
SJ	1800 mm.	300/400 mm.	500 mm.	2

A las medidas indicadas se le incrementará la parte correspondiente a las patas de la taquilla. In above measures, you will increase the dimension of support floor-locker.

GAMA DE COLORES STOCK | STOCK RANGE OF COLOURS

Azul Claro | Light blue Gris oscuro | Dark grey Gris claro | Light grey

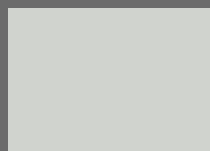

Rojo | Red



Negro | Black

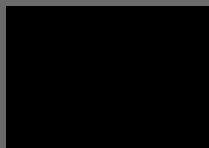

Amarillo | Yellow



Blanco | White

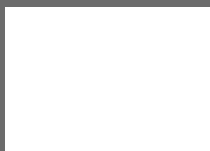

Verde | Green

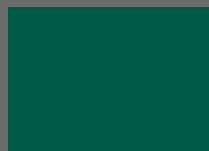

Azul | Blue

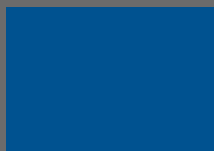

COMPLEMENTOS | COMPLEMENTS



Techo inclinado | Gable roof



Resbalón, moneda | Removable cylinder, coin



Soporte suelo-taquilla | Support floor-locker



Bisagra | Hinge

- Estructura metálica.
 - Tablero compacto fenólico de 12 mm.
 - Resistentes al rayado, al desgaste y comportamiento seguro al fuego. Superficie no porosa, repele la suciedad. Mantenimiento sencillo.
 - Medidas estándar y no necesita montaje
 - Opción de parrilla, perchas...
-
- Metal structure
 - Phenolic compact panels of 12 mm.
 - Scratch and wear resistance and a sure behavior against fire. Surface non-porous; dirt does not adhere to it. Simply maintenance.
 - Standard dimensions and it is not necessary any assembly.
 - Option: shoe rack, hooks...

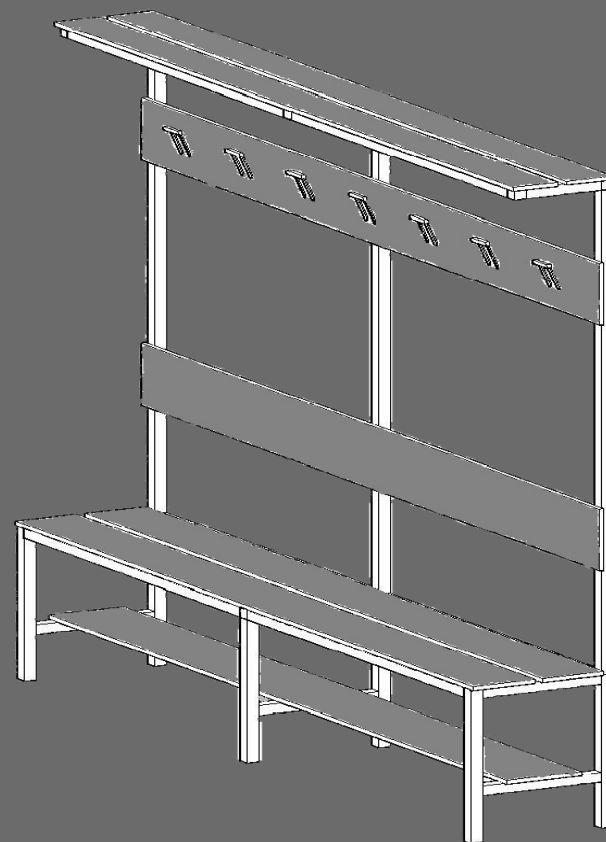

Bancos sencillos | Simple benches

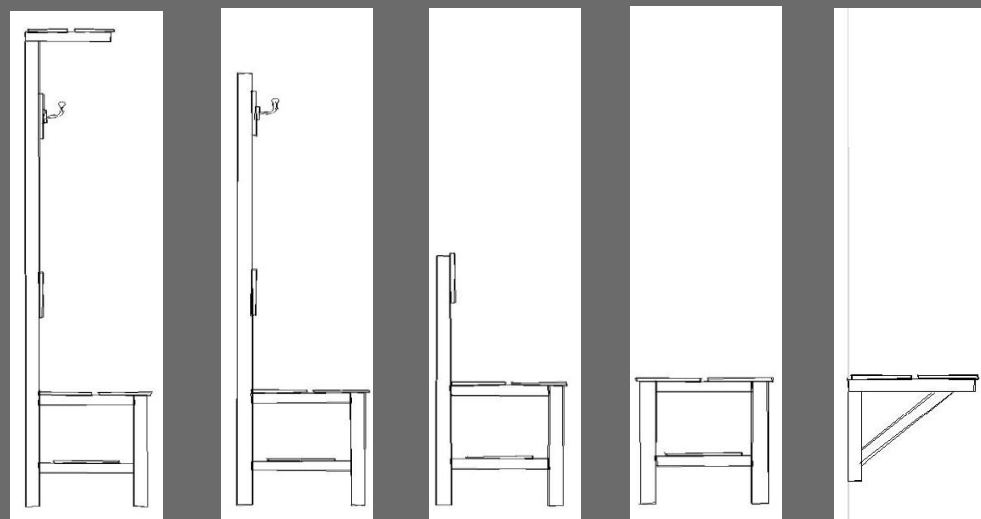

BS-R1

BS-R2

BS-R3

BS-R4

BS-R5

Bancos dobles | Double benches

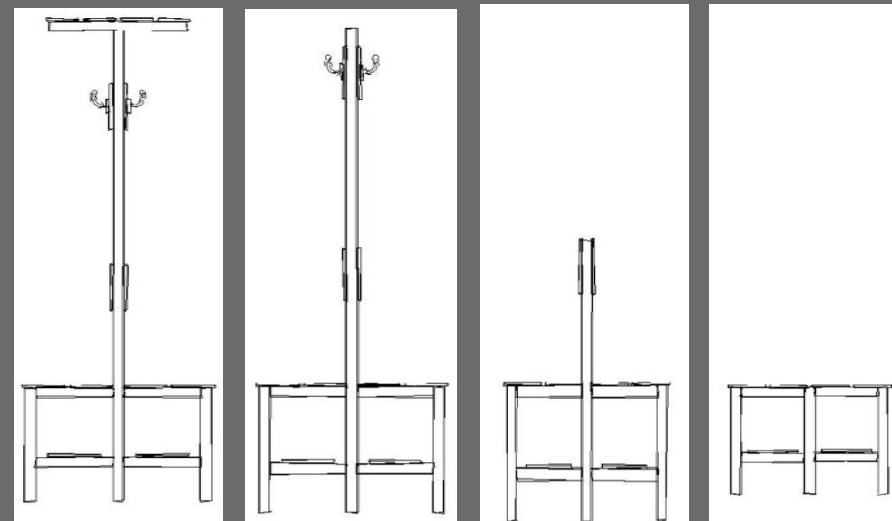

BD-R1

BD-R2

BD-R3

BD-R4

Bancos: Gama de colores y medidas | Benches: Range of colours and measures

GAMA DE COLORES EN STOCK | STOCK RANGE OF COLOURS

Azul Claro | Light blue Gris oscuro | Dark grey Gris claro | Light grey

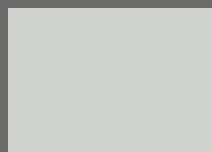

Rojo | Red



Negro | Black

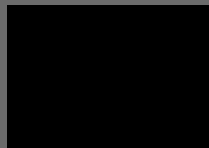

Amarillo | Yellow



Blanco | White

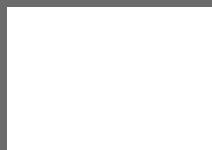

Verde | Green

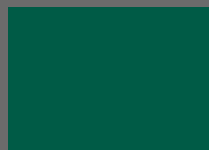

Azul | Blue

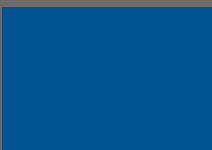

MODELO BANCO	ALTO ↑ ↓	ANCHO ← →	FONDO ↖ ↗	Nº PERCHAS Nº HOOKS
BS-R1	-----	1000/1500/2000 mm.	440 mm.	4/6/8
BS-R2	1650 mm.	1000/1500/2000 mm.	440 mm.	4/6/8
BS-R3	825 mm.	1000/1500/2000 mm.	390 mm.	-----
BS-R4	410 mm.	1000/1500/2000 mm.	390 mm.	-----
BS-R5	410 mm.	1000/1500/2000 mm.	390 mm.	-----
BD-R1	1810 mm.	1000/1500/2000 mm.	840 mm.	8/12/16
BD-R2	1650 mm.	1000/1500/2000 mm.	840 mm.	8/12/16
BD-R3	625 mm.	1000/1500/2000 mm.	740 mm.	-----
BD-R4	410 mm.	1000/1500/2000 mm.	740 mm.	-----

Desde siempre SPIGO GROUP ha tenido una especial consideración con el medio ambiente; siendo una de las primeras empresas dentro de su sector en conseguir la certificación ISO 14001. Además, para garantizar la calidad y el servicio a nuestros clientes la empresa desarrolla importantes esfuerzos en la mejora continua; así como la consecución y mantenimiento del certificado de calidad ISO 9001.

SPIGO GROUP has always taken the care for the environment into special consideration, being one of the first companies in the sector to receive the ISO 14001 certification. Furthermore, to ensure the quality and service to our customers, the company is carrying out significant efforts on continuous improvement, as well as on the achievement and maintenance of the ISO 9001 quality certificate.







CARPINTERIA PACO, S.L.

Polígono Industrial Cantabria II. C/ Las Cañas, 19. 26009 Logroño (La Rioja)
Telf.: 941 24 47 77 / Fax: 941 26 15 80
e-mail: comercial@spigogroup.com
www.spigogroup.com

